

This room can be partitioned into three distinct areas each with separate functions.

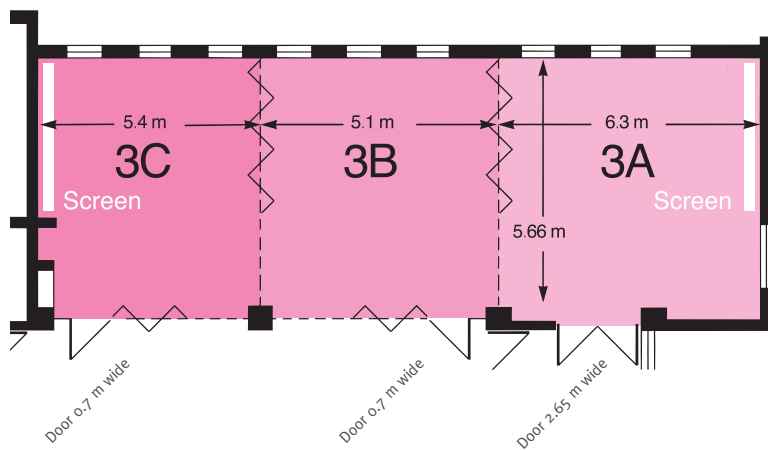
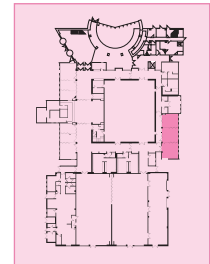

Ceiling height 2.99 m

Clear access height 2.54 m

FACILITIES

AREA

		COMPLETE SUITE	A	B	C	A and B	B and C	
Capacities	Theatre style	120	45	25	30	60	55	
	Board room	60	18	12	18	40	30	
	Classroom	45	18	12	18	30	30	
Lighting	Fluorescent	yes	yes	yes	yes	yes	yes	
	Controls in room	yes	yes	yes	yes	yes	yes	
	Blackout to windows	yes	yes	yes	yes	yes	yes	
Sound	Sound system	stereo	no	no	no	no	stereo	
	Number of speakers	2	0	2	0	2	2	
	Number of mike inputs	3	0	0	3	0	3	
	Number of line inputs	1	0	0	1	0	1	
	Controls in room	yes	yes	yes	yes	yes	yes	
Power	13 amp sockets		Perimeter trunking with 96 x 13 amp sockets					
Projection	Number of screens	2	1	0	1	1	1	
	Size	1.92x3.63 1.92x4.41	1.92x3.63		1.92x4.41	1.92x3.63	1.92x4.41	
	Height off floor	0.97 m	0.97 m		0.97 m	0.97 m	0.97 m	
Communications	Telephone points	7	2	2	3	4	5	
	Data	7	2	2	3	4	5	