

This room can be partitioned into three distinct areas each with separate functions.

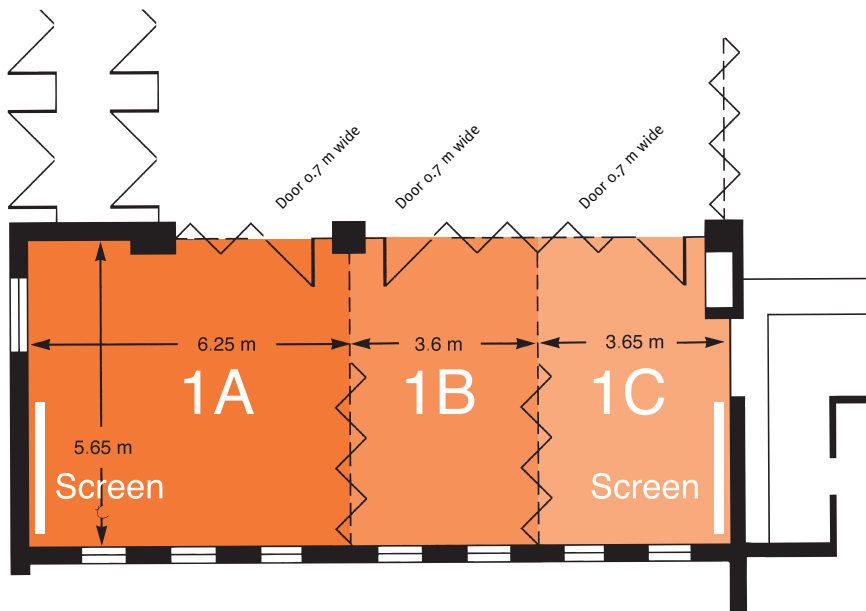
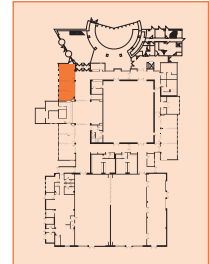

Ceiling height 2.99 m

Clear access height 2.54 m

## FACILITIES

		AREA	A	B	C	A and B	B and C
		COMPLETE SUITE					
Capacities	Theatre style	100	40	20	30	70	50
	Board room	42	18	12	16	30	24
	Classroom	40	12	11	13	28	17
Lighting	Fluorescent	yes	yes	yes	yes	yes	yes
	Controls in room	yes	yes	yes	yes	yes	yes
	Blackout to windows	yes	yes	yes	yes	yes	yes
Sound	Sound system	stereo	stereo	stereo	stereo	stereo	stereo
	Number of speakers	2	0	2	0	2	2
	Number of mike inputs	3	0	0	3	0	3
	Number of line inputs	1	0	0	1	0	1
	Controls in room	yes	yes	yes	yes	yes	yes
Power	13 amp sockets		Perimeter trunking with 84 x 13 amp sockets				
Projection	Number of screens	2	1	0	1	1	1
	Size	1.92x2.62 1.92x3.62	1.92x3.62		1.92x2.62	1.92x3.62	1.92x2.62
	Height off floor	0.97 m	0.97 m		0.97 m	0.97 m	0.97 m
Communications	Telephone points	12	5	3	4	8	7
	Data	7	3	2	2	5	4