

General Layout

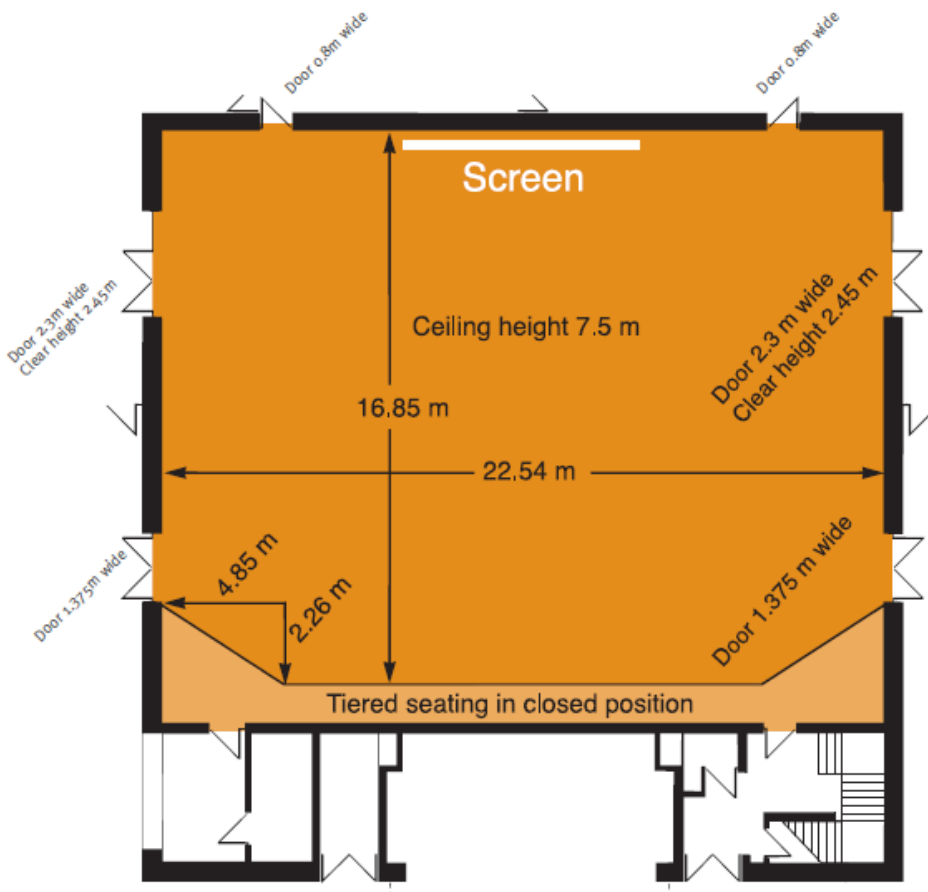
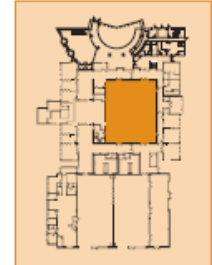

FACILITIES		AREA PROVISION	FACILITIES		AREA PROVISION	
Capacities	Theatre style	520	Power	13 amp sockets in perimeter trunking and central floor duct	yes	
	Classroom	80		3 phase up to 100 amps	yes	
	Dining no stage	192		Projection facilities	Number of screens	1
	Buffet Reception	300			Size	2.98x8.56m
	Exhibitions	To suit			Height off floor	1.5m
Lighting	Fluorescent/dimmers	yes	Projection room	yes		
	Spotlights	Adjustable	Communications	Telephone points	2	
	Controls in room	yes		Data	3	
	Lighting bar height	7.31				
	Dimmers	yes				
	Blackout to windows	yes				
Sound	Sound system	stereo				
	Number of speakers	10				
	Number of mike inputs	32				
	Number of line inputs	32				
	Mixing	yes				
	Controls in projection room	yes				

Tiered Theatre

The balcony level seats are permanently fixed

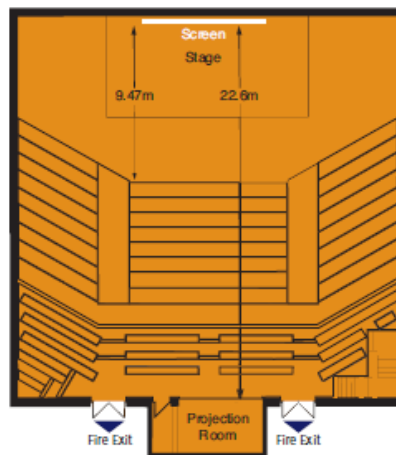

Banquet

The raked seating shown fully retracted

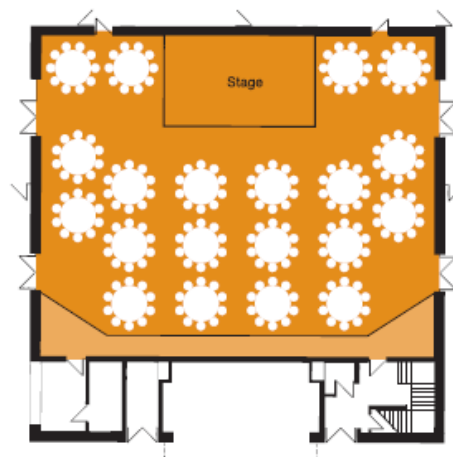

Flat Theatre

The raked seating shown fully retracted

